

CELLULAR 2.0 SKYLIGHT INSTALLATION INSTRUCTIONS

Hardware Included:

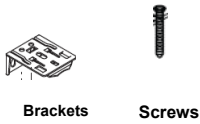

Tools Required:	Shade Width	Brackets (2 screws per bracket)	Side Rail Screws
<ul style="list-style-type: none"> Screwdriver Hex Bit Measuring Tape Pencil 	Up to 47.9"	4	4
	48" - 60"	6	6

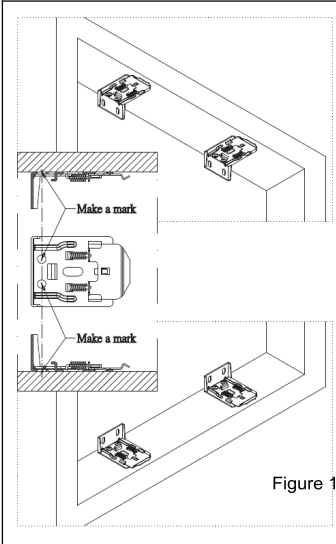

Step 1 - Bracket Installation

- Mark where the brackets will be installed for both top and bottom of the skylight frame.
- Make sure the brackets are lined up identically across the same frame and opposite frame.
- Fasten all brackets.

Step 2 - Shade Installation

- Decide which side of the skylight frame is top and which side is bottom.
- Install the headrail and bottom rail to brackets.
- Cord should have tension.

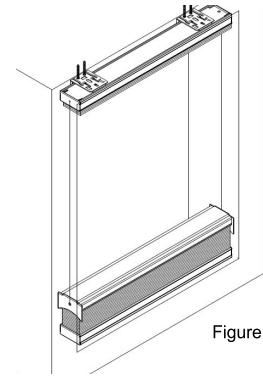

CELLULAR 2.0 SKYLIGHT INSTALLATION INSTRUCTIONS

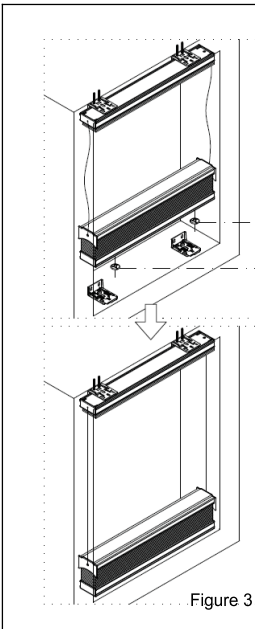

Step 3 - Shade Tension

- Operate the shade to make sure the middle rail is leveled and the cord has good tension.
- If the cord is not tight, remove the bottom rail from the brackets. Loosen the cords from the fix button and move the button upward. Tie the cord on the fix button.
- Repeat the same process on the other fix button. Install the bottom rail on the brackets again to make sure the middle rail is leveled and operates smoothly.

Step 4 - Prep for Side Rail

- Remove the Bottom Rail from the brackets (Figure 4)

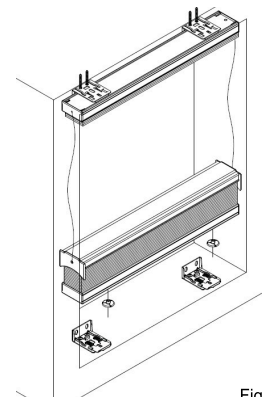

CELLULAR 2.0 SKYLIGHT INSTALLATION INSTRUCTIONS

Step 5 - Side Rail Installation

- A. Slide middle rail endcap into the slide channel of the side rail.
- B. Move the side rail all the way up to the top of the headrail.
- C. Position the side rail where it is to be installed. If the rail does not easily swing into the opening, remove the top as well and insert the Side channel into the opening and then reinstall the top rail before continuing.
- D. Fasten one screw through the side rail to the skylight frame.
- E. Do not tighten it.
- F. Repeat this process on the other side channel.

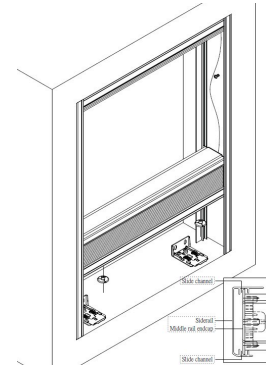

Figure 5

Step 6 - Re-Install the Bottom Rail

- A. Install the bottom rail back on the brackets.
- B. Test the Shade.

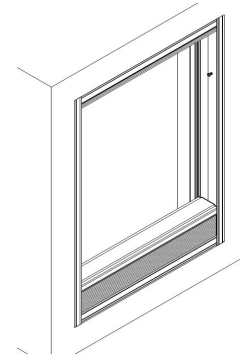

Figure 6



EcoSmart Shades

Rev 1.2 07.30.2025

CELLULAR 2.0 SKYLIGHT INSTALLATION INSTRUCTIONS

Step 7 - Final Touches

- A. Fasten a second screw on each side rail.
- B. Tighten the first screw on the side rail.
- C. Installation is complete.

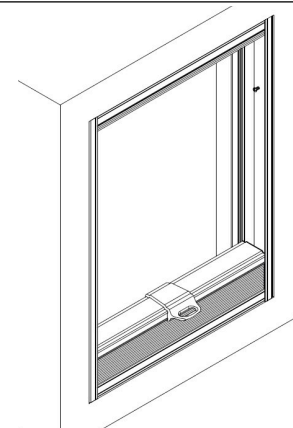

Figure 7



EcoSmart Shades

Rev 1.2 07.30.2025